

# A Plat of an Addition to the Town of Seattle.

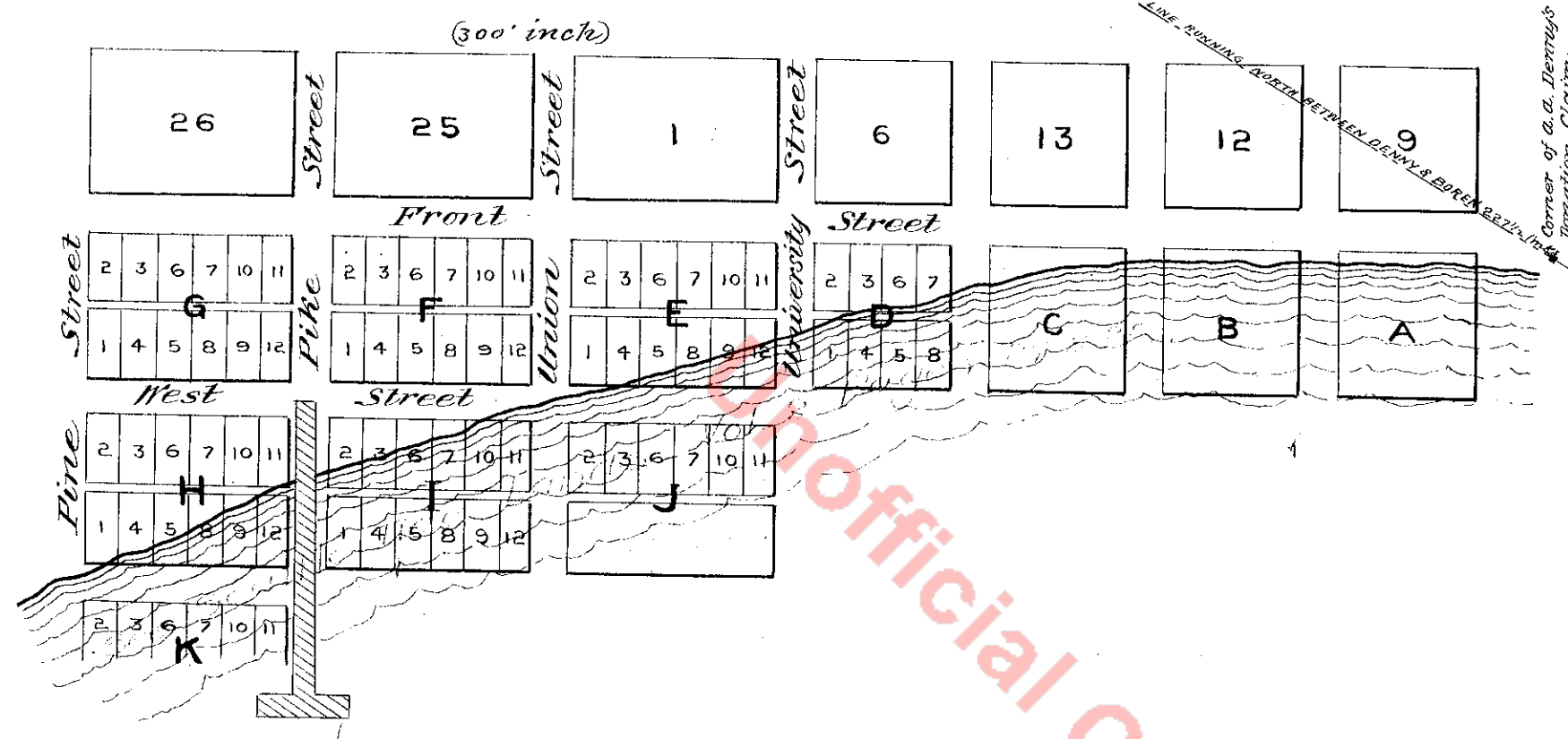

Laid off by A. A. Denny the Blocks A. B. C. 9. 12. 13. 6. 1. 25 and 26 are given to show the connection this Addition and the plats previously recorded. Lots, Streets and Alleys are as herein shown, and correspond in all respects with the Original Plats.

Seattle August 28<sup>th</sup> 1871

A. A. Denny.

Territory of Washington }  
County of King }  
Personally appeared before me A. A. Denny, proprietor of this Addition to the Town of Seattle, and acknowledged that he executed the above Town Plat of the same for the uses and purposes therein Expressed.

In witness whereof I have hereunto set my hand and affixed my official seal at Seattle this 29<sup>th</sup> day of August A. D. 1871

David T. Denny, Probate Judge Seal

Recd for Record August 30<sup>th</sup> 1871 - 2 O'Clock P.M.

G. Kellogg Auditor

Recorded in the Records of King County, Washington Territory, in Vol 5 of Deeds on page 317. Re-recorded (per order Com's Court) this 23<sup>rd</sup> day of Feby, 1875

S. C. Harris, Draughtsman,