

PLAT OF AN ADDITION TO THE TOWN OF SEATTLE.

Which connects with that portion heretofore laid off by me and
Recorded April 22nd 1869 in Vol. 2 page 196 and corresponding therewith
in size of lots and width of streets and alleys, A. A. Denny Proprietor.

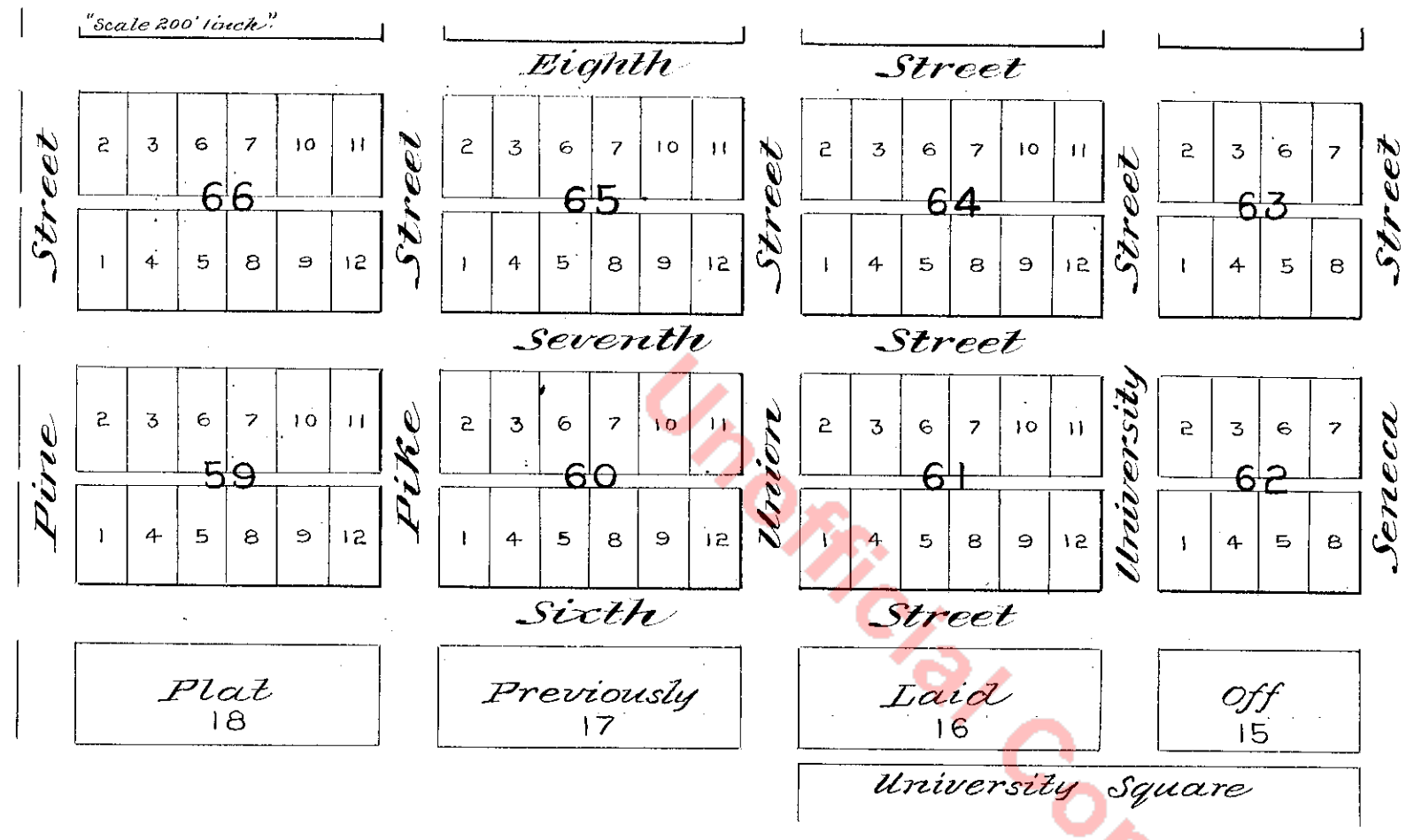

Territory of Washington }
County of King }

On this 12th day of December 1872 before me County Auditor of King
County W.T. personally came A. A. Denny to me known to be the person who executed
and the proprietor of the above Town Plat, and acknowledged that he executed it for the
purposes therein stated.

In witness whereof I have hereunto set my hand, and official seal the day and year above
written.

J. T. Wheeler, Auditor of King Co. W. T.

Filed for Record Dec 12th 1872 at 12 o'clock M. J. T. Wheeler Auditor.

This will certify that the foregoing is a true Copy of the Record of the Plat of an Addition
to Seattle (laid off by A. A. Denny) as Recorded in Vol 6 of Deeds Page 800, Records of
King County Washington Territory, Witness my hand this 13th day of February A. D. 1875

S. C. Harris Draughtsman.
Seattle W. T.

SEE SURVEY VOL 9 PAGE 166