

BLUFF PARK

Addition to the

CITY OF SEATTLE

Scale 80ft. = 1 in.
Scale of Records 150ft. = 1 inch.

J. H. Thomason
Civil Engineer.

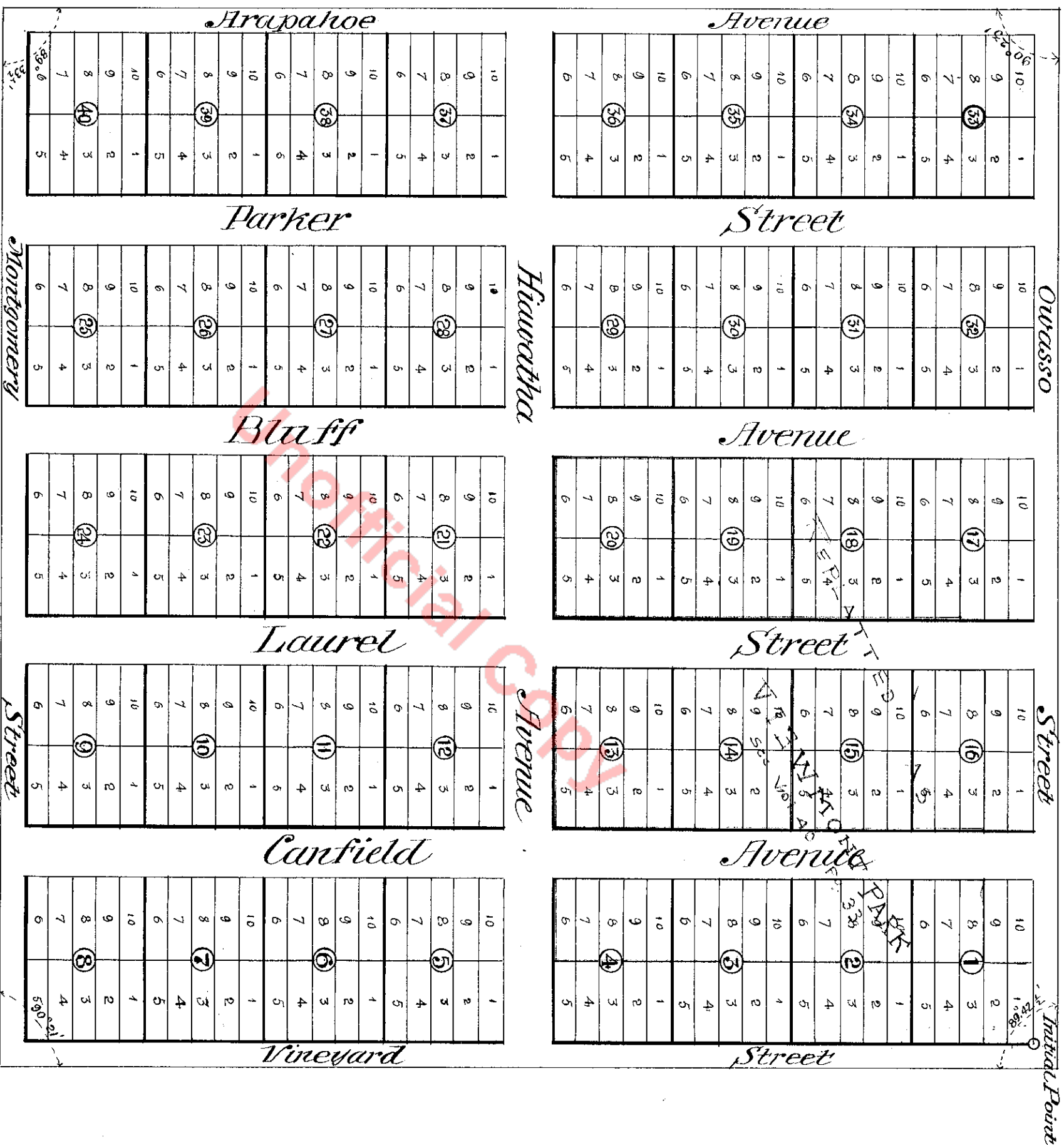

DESCRIPTION.

This Addition covers the N^W ¼ of the S. E. ¼ of Sec. 15 Township 25 N. R. 3 E. 3 E. 3 M. The initial point is the N. E. corner of Block 1 and is 30ft. south of and 1350ft. west of the ¼ section corner on the E. boundary of said Sec. 15. Outwasso, Haurathia and Montgomery Streets, and Hrapalhoe Avenue are each 30ft. wide. Parker and Laurel Streets and Bluff, Canfield and Haurathia Avenues are each 60ft. wide. Lots are 30 x 102.04 ft.

45563.

This is a record of the request of J. H. Glass, Jan. 13th A. D. 1890, at 45 min. past 12 M. and recorded in Vol. II of Records of King County, Wash. Page 79. J. H. Thomason, County Auditor.

DEDICATION.

I, Avery Parker, present owner in fee simple of the above described Bluff Park Addition, do hereby declare this plat and dedicate to the use of the public forever all the streets and avenues platted therein. In witness whereof I have hereunto set my hand and seal this Third day of July in the year eighteen hundred and ninety.

In presence of
J. S. Pettit
Mellis B. Herz

Avery Parker

ACKNOWLEDGMENT.

I, State of Colorado }
County of Hrapalhoe }
This is to certify that on this Third day of July, A. D. 1890, before me, the undersigned, a Notary Public in and for Hrapalhoe Co. did come Avery Parker, known to me to be the person who executed the foregoing instrument and he acknowledged to me that he signed and sealed the same freely and voluntarily and for the uses and purposes therein mentioned.

In witness whereof I have hereunto set my hand and affixed my official seal on the day and year first above written.



Albert S. Pettit
Notary Public.

H. B. Co. Rec.